

Central Coast GIS User Group

11/09/2016

Location: Lincoln County Surveyors Office

880 NE 7th St– Newport, OR 97365

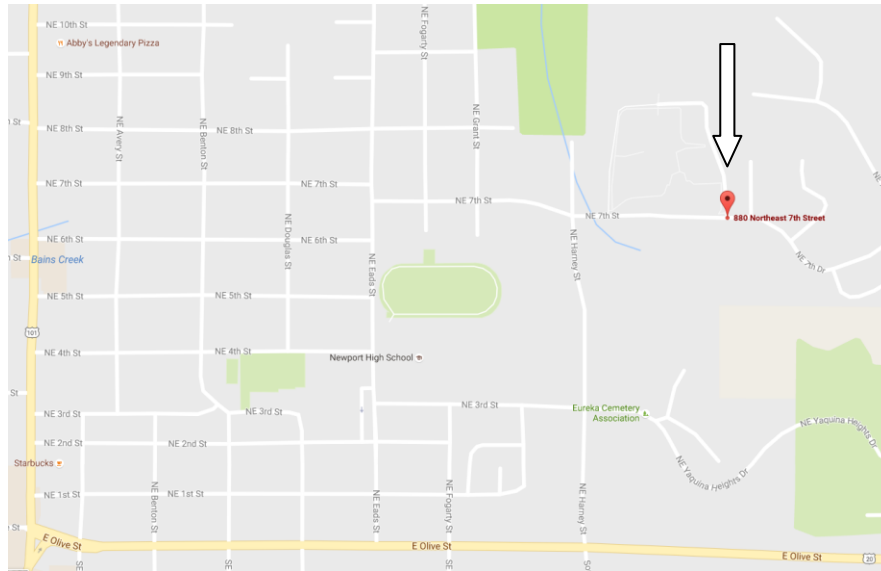

- I. Introductions and quick update on current projects
- II. Business Meeting: Future of the Group
 - a. Reduce number of mtgs?
 - b. Symposium yearly or every other year?
 - c. Have two informal mtgs after work?
 - d. Go dormant?
 - e. Other options?
- III. CCGISUG Election of Officers – if needed
 - a. President
 - b. Treasurer
 - c. Secretary
 - d.
- IV. GeoTrivia: Sandy Gruber
- V. Map Critiques, Issues, Questions
- VI. 2017 Meeting Schedule